



## REQUIREMENTS TO FACILITATE INSTALLATION OF SPORTS HALL WALL IMPACT PANNELLING



Continental Sports' sports hall wall panelling / impact panelling provides a perfect internal wall fascia to sports halls and activity rooms. It offers the following benefits:

- Aesthetic improvements by hiding blockwork or metsec walls
- Provides an attractive durable finish that is resistant to impacts from balls and people
- Perforated panels provide opportunity for aesthetically attractive arrangements as well as acoustic enhancement.



TIMBER FRAMEWORK BEFORE INSTALLATION OF IMPACT PANELS

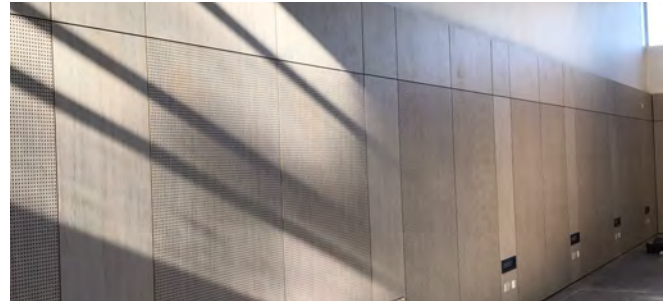

IMPACT PANELS AFTER INSTALLATION



SOLID PANEL

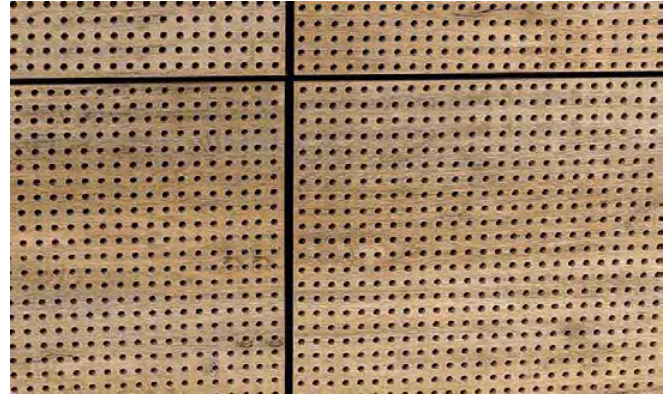

PERFORATED (ACOUSTIC) PANEL

- **Durability & Impact Resistance** – Provides superior impact resistance from balls, equipment and hall users. This allows for both solid and acoustic panels to be used from floor to soffit.
- **Time & Cost Savings** – The structural integrity of the panels enables them to be installed as an independent wall system which can be fixed directly to studwork. This eliminates the need for block work and other wet trades, providing a fast and efficient installation.
- **Factory Finished** – Every panel is factory finished with a low maintenance, UV resistant, durable surface that does not require re-finishing over the life of the product.
- **Secret Clip Fixings** – The supplied secret clips offer a fast and easy panel installation which eliminate unsightly surface fixings. They also provide a consistent spacing between adjoining boards.
- **Fire Performance** – The panels are fire rated to comply with all relevant Building Regulations.
- **Colours** - The panels are available in a wide range of colours & wood effects: [Colour Chart](#)

## TECHNICAL & PERFORMANCE SPECIFICATIONS - SOLID & PERFORATED (ACOUSTIC) PANELS

<b>Panel Face</b>	Factory finished, available in a range of colours & wood effect finishes
<b>Panel Core</b>	Fire Rated MDF
<b>Fire Performance</b>	Fire rated to European Class B - S1-d0
<b>Panel Sizes</b>	Standard full panels: 2.4m x 1.2m x 18mm Other part panel sizes available to suit specific design requirements
<b>Compliance</b>	Building Regulations & Sport England compliant
<b>Panel Weight</b>	<i>Perforated: 12.85kg /m<sup>2</sup></i> <i>Solid: 13.72kg / m<sup>2</sup></i>
<b>Acoustic Performance</b>	Class C - Perforated panels with insulation

### METHOD OF INSTALLATION

Continental's sports hall wall panelling provides a fast and efficient sports wall solution. The panels are manufactured from engineered timber. The structural integrity allows the panels to be installed as an independent wall system which eliminates the need for blockwork and other wet trades.

The intended method of installation is for the substructure to be constructed true both vertically and horizontally, this could be a wall or a SFS framing system. Horizontal timber studs are then installed to accommodate the fixing of the black acoustic fleece and secret fixing clips.

The black fleece is placed over the timber studs to create a shadow gap between the panels and make the black metal brackets appear invisible.

The panels are then installed using the supplied secret clips to ensure a consistent 7mm spacing between adjoining boards.

NB: 5/3/2025

Insulation can be incorporated behind the panels to enhance thermal resistance and acoustic performance:



**INSULATION IS PLACED BEHIND THE PANELS TO ACHIEVE REQUIRED THERMAL AND ACOUSTIC VALUES.**



**A BLACK ACOUSTIC FLEECE IS INSTALLED BEHIND THE PANELS TO HIDE STUDWORK AND DISGUISE THE FIXING CLIPS.**

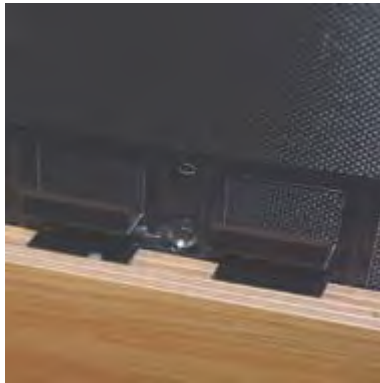

**THE PANELS ARE FIXED USING THE SECRET CLIPS WHICH ARE TO BE PLACED INTO THE PRE-ROUTED EDGES TO LEAVE THE APPEARANCE OF A FIXTURE FREE INSTALLATION.**



**AT THE CORNERS THE CLIPS SHOULD BE MOUNTED VERTICALLY TO CAPTURE THE BOARD YOU ARE FIXING AND THE NEXT. THE SCREWS SHOULD BE BLACK SO AS TO APPEAR INVISIBLE ONCE FIXED THROUGH THE CLIPS.**

## **FEATURES IMPACTING THE FINISH OF THE INSTALLATION**

### ***Protrusions through the panels such as electrical sockets:***

1. 1st fix installation of electrical provisions is necessary before the installation of the panels
2. Drawing to be provided to Continental Sports Ltd showing locations and sizes of openings to be created
3. Continental technicians create cut-outs
4. 2nd fix of surface mounted items (socket fascias, alarm sensors etc.)

NB: 5/3/2025



**Windows and doors:**

1. Consider whether the panelling and windows / door sill, header and jamb are to be finished flush with the internal wall panelling face
2. Timber provisions (18mm thick plywood minimum required around the perimeter of doors / windows set 19mm back from the wall panelling face location



3. Architraves if required can be installed by others after the wall panelling

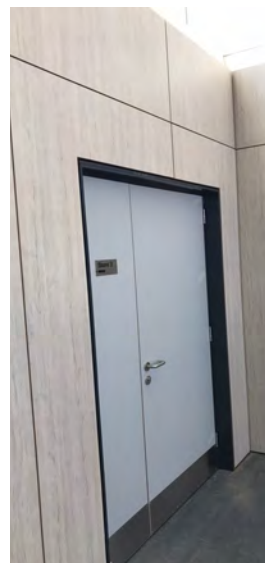

NB: 5/3/2025

## Skirting:

Skirting to cover the interface between the wall panels and flooring is optional. However we require a 25mm gap underneath the bottom edge of the first run of panels. Therefore skirting may be necessary to cover this gap. Skirting is to be supplied and installed by others. Two examples of typical skirting installations are shown below:

Scenario 1.

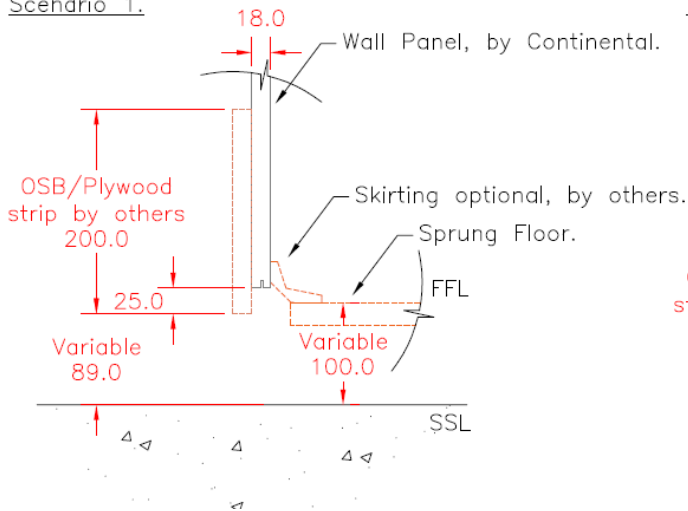

Scenario 2.

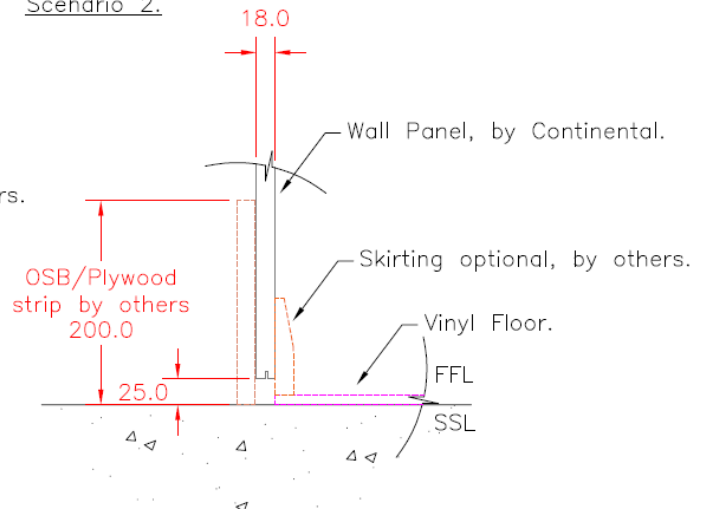

## BUILDERS WORK REQUIREMENTS

We require plywood strips to be installed onto which the invisible panel clips are fixed - please refer to drawing 111-25-01 and 111-25-02. Those plywood strips can be installed as BWIC or we can provide pricing to install. Please note that the vertical and horizontal alignment of the wall panels is dependent upon the trueness of the substructure and those plywood strips.

Continental Sports Ltd. is not responsible for ensuring the trueness of the substructure. Any misalignment of the panels resulting from an out-of-true substructure will not be the responsibility of Continental Sports Ltd.

## FURTHER ADVICE AND GUIDANCE

Richard Cooper  
Head of Technical  
01484 542 051  
richard@contisports.co.uk

Troy Heptinstall  
Head of Sales  
01484 542 051  
troy@contisports.co.uk

NB: 5/3/2025

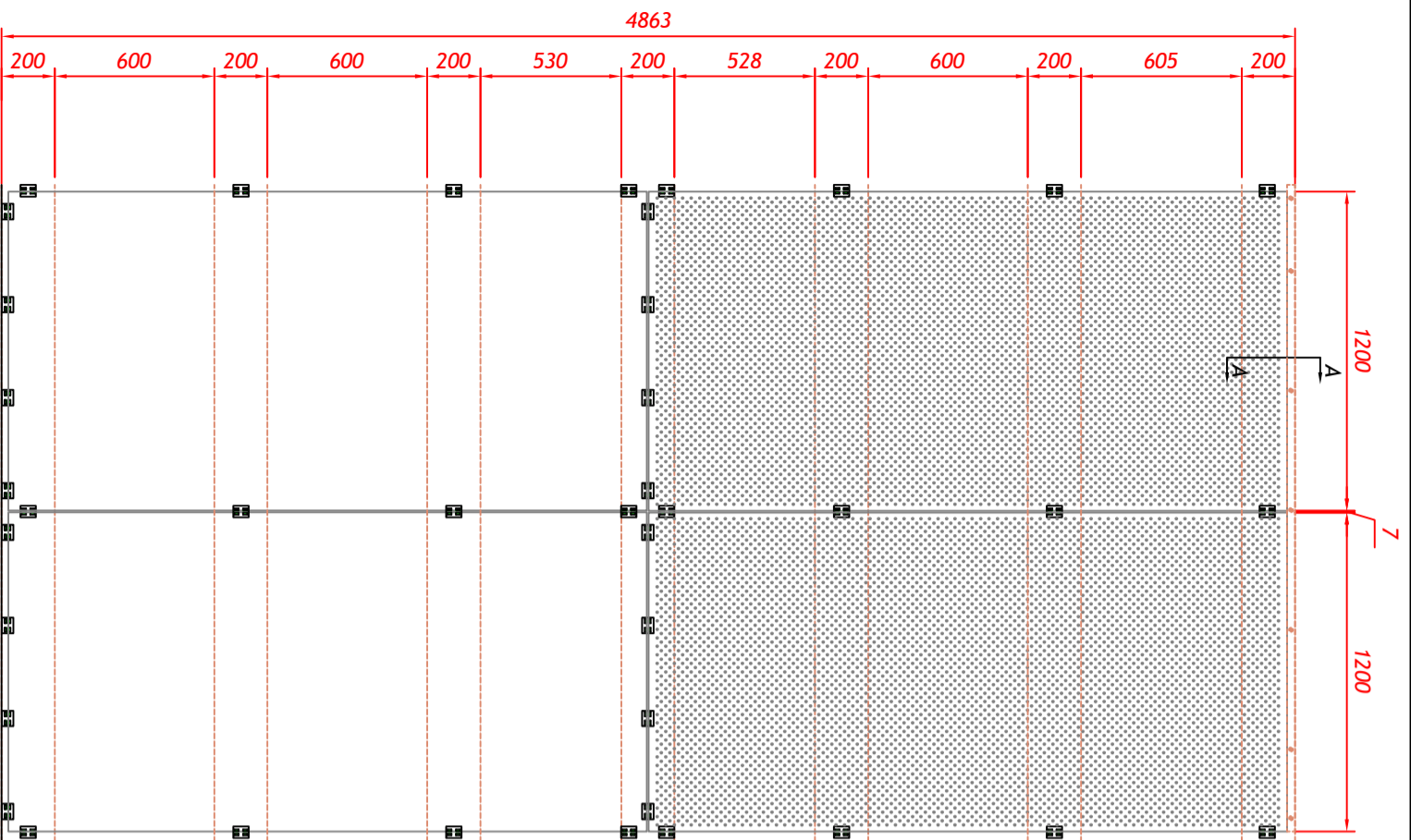

**Option 1:**

1no 1.2m x 2.4m Solid Panel

1no 1.2m x 2.4m Perforated Panel

200mm x 18mm Horizontal OSB/Plywood strips required by others to accommodate the fixing clips.

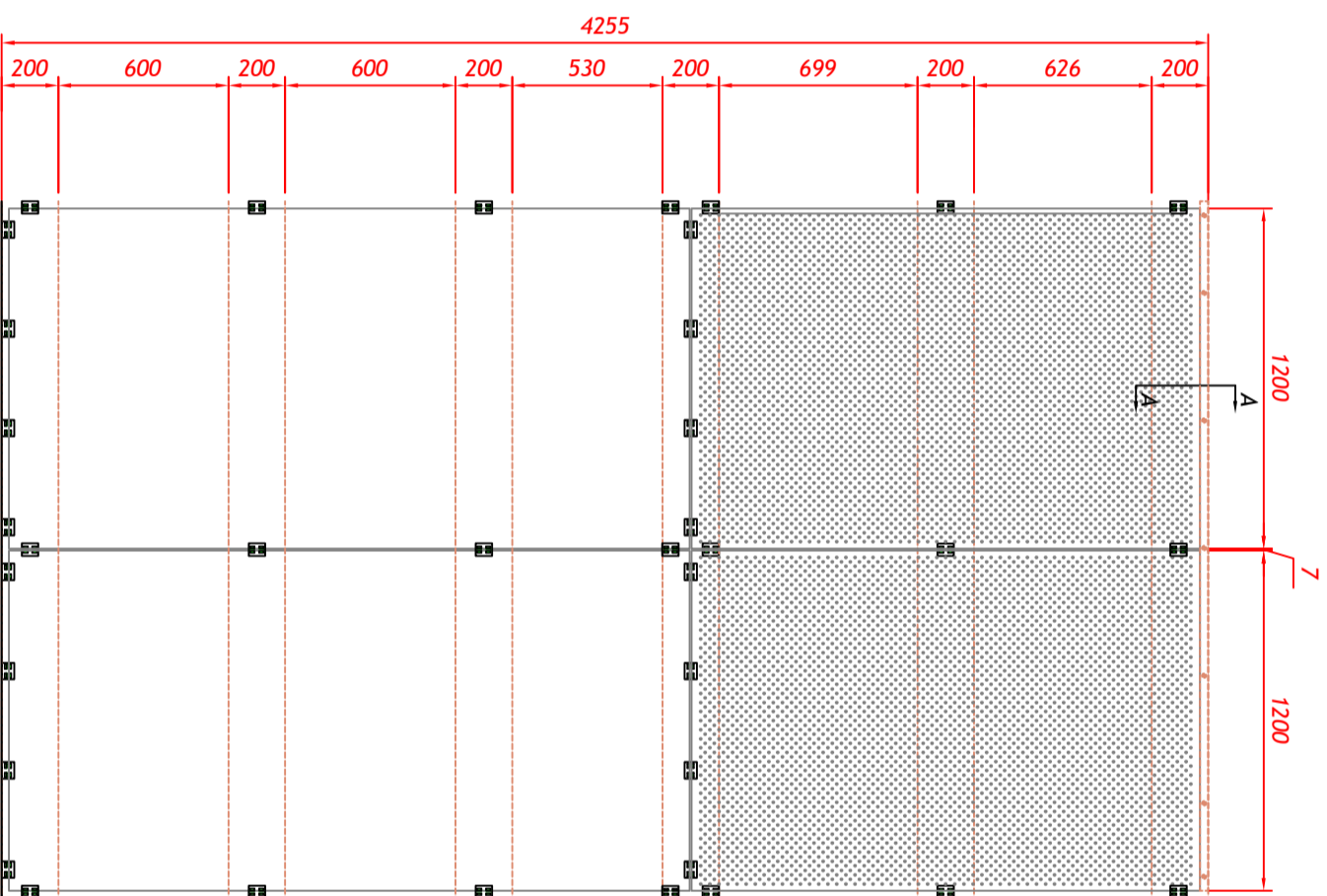

**Option 2:**

1no 1.2m x 2.4m Solid Panel

1no 1.2m x 1.8m Perforated Panel

200mm x 18mm Horizontal OSB/Plywood strips required by others to accommodate the fixing clips.

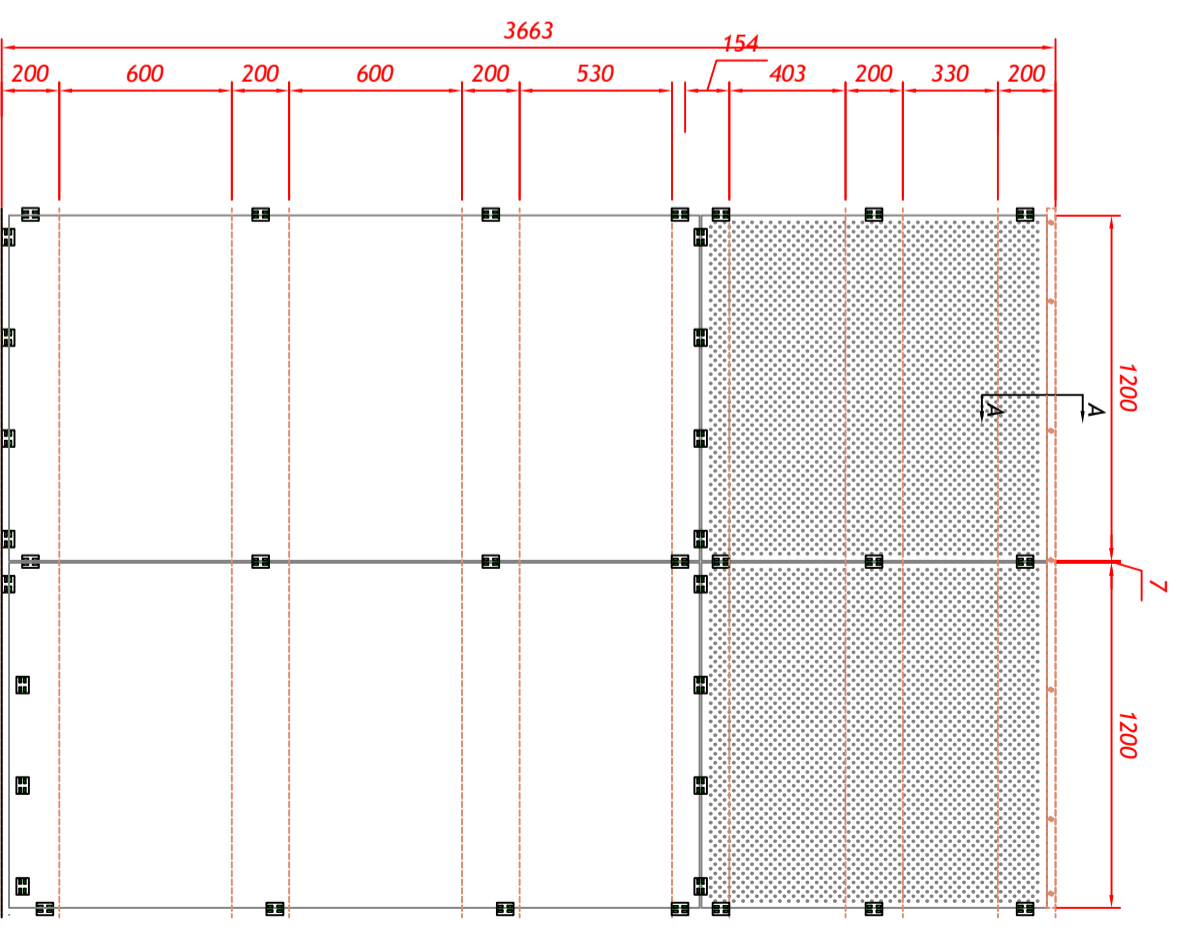

**Option 3:**

1no 1.2m x 2.4m Solid Panel

1no 1.2m x 1.2m Perforated Panel

200mm x 18mm Horizontal OSB/Plywood strips required by others to accommodate the fixing clips.

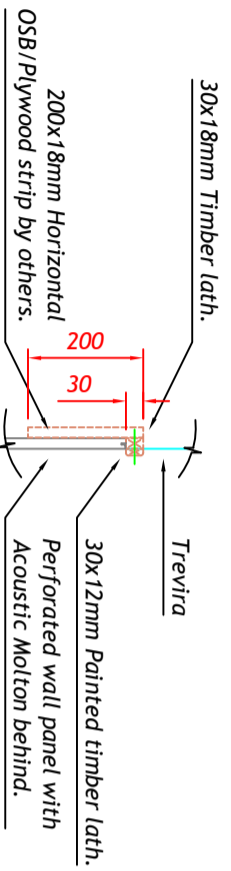

Typical View on section A-A (Scale 1:10)

**NOTE:**

The vertical and horizontal alignment of wall panels is dependent upon the trueness of the substructure (e.g., SFS). Continental Sports Ltd. is not responsible for ensuring the trueness of the substructure. Any misalignment of the panels resulting from an out-of-true substructure will not be the responsibility of Continental Sports Ltd.



Continental Sports Limited  
Peddock, Huddersfield HD1 4SD  
Tel: Huddersfield (01484) 540051 Fax: (01484) 539148  
Website: <http://www.continentsports.co.uk>  
E-Mail: [sales@continentsports.co.uk](mailto:sales@continentsports.co.uk)

Continental Sports Limited accepts no responsibility for ensuring compliance of this layout with any relevant legislation.

**Example Portrait Wall Panel installation scenarios inc Trevira fabric cladding.**

© Continental Sports Limited and any supplementary information issued shall remain vested in Continental Sports Limited. It shall not be passed to any other party without the express written consent of an authorised director of Continental Sports Limited.			
Tolerances as detailed on SPED01 unless noted on the dimension.			
ALL DIMENSIONS ARE GIVEN IN MILLIMETRES. DO NOT SCALE OFF DRAWING.			
scale	date	dr	rev
A2@1:20	03-03-25	TJH	A
projection	dwg no		
	111-25-01		

A: TJH, 03-03-25, ORIGINAL ISSUE.



Option 1:  
 2no 1.2m x 2.4m Solid Panels  
 2no 1.2m x 2.4m Perforated Panels  
 200mm x 18mm Horizontal OSB/Plywood strips required by others to accommodate the fixing clips.

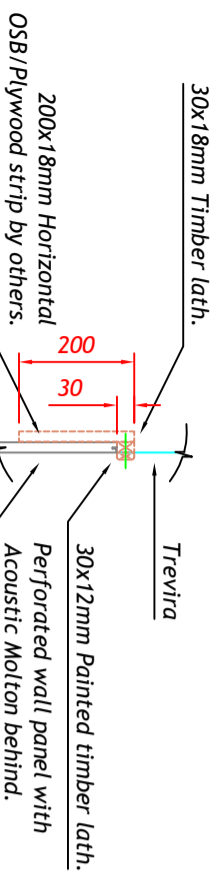
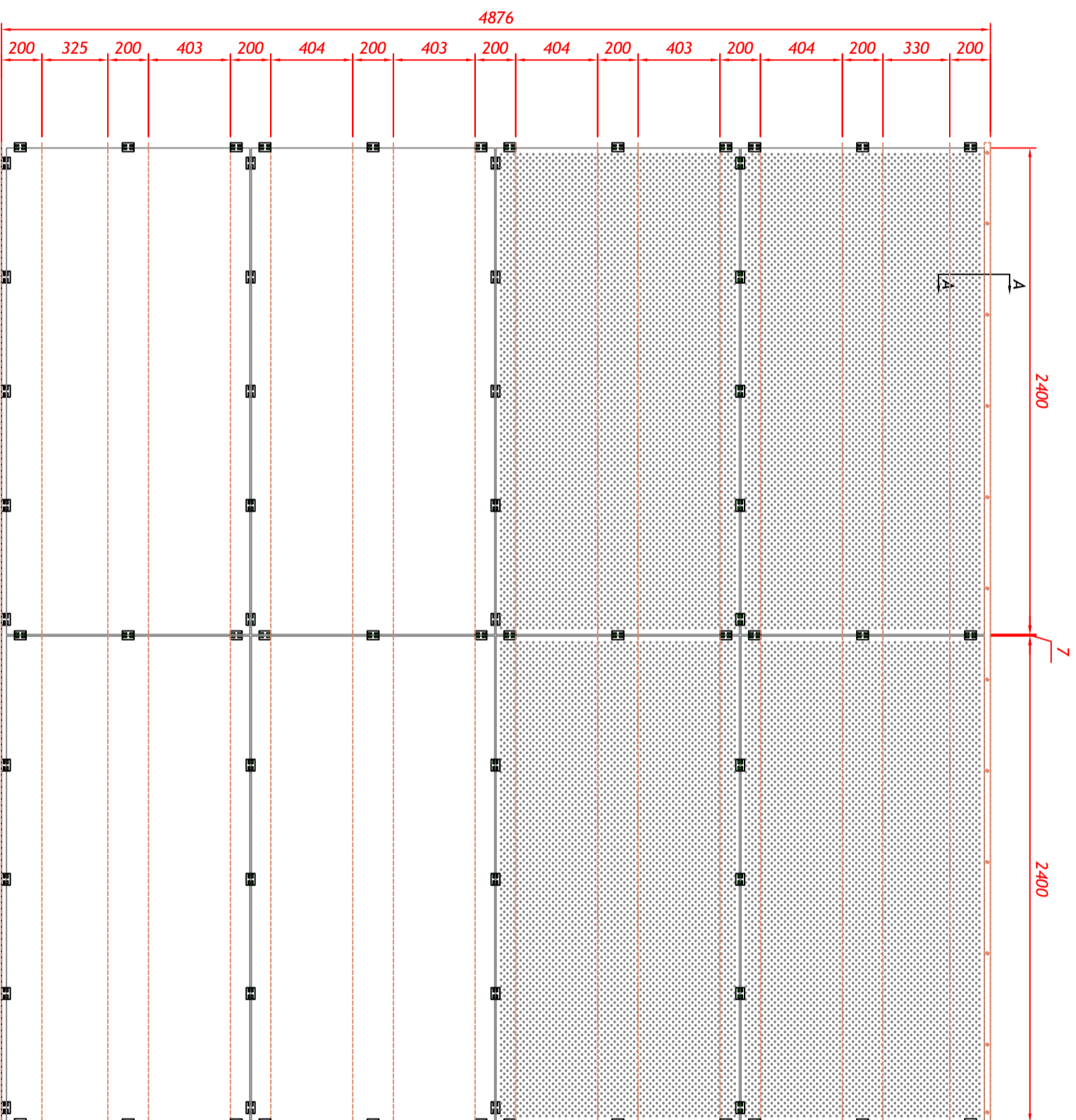

Typical View on section A-A (Scale 1:10)

**NOTE:**

The vertical and horizontal alignment of wall panels is dependent upon the trueness of the substructure (e.g., SFS). Continental Sports Ltd. is not responsible for ensuring the trueness of the substructure. Any misalignment of the panels resulting from an out-of-true substructure will not be the responsibility of Continental Sports Ltd.

© Continental Sports Limited  
 and any supplementary  
 information issued shall remain vested in Continental Sports  
 Limited. It shall not be passed to any other party without the  
 express written consent of an authorised director of  
 Continental Sports Limited.

Tolerances as detailed on SPED01 unless noted  
 on the dimensions.  
 ALL DIMENSIONS ARE GIVEN IN MILLIMETRES.  
 DO NOT SCALE OFF DRAWING.

A: TJH, 03-03-25, ORIGINAL ISSUE.



Continental Sports Limited  
 Peddock, Huddersfield HD1 4SD  
 Tel: Huddersfield (01484) 540051 Fax: (01484) 539148  
 Website: <http://www.continentsports.co.uk>  
 E-Mail: [sales@contisports.co.uk](mailto:sales@contisports.co.uk)

Continental Sports Limited accepts no  
 responsibility for ensuring compliance of this layout  
 with any relevant legislation.

**Example Landscape Wall Panel  
 installation scenario inc Trevira  
 fabric cladding.**

scale	date	dfr	rev
A2@1:20	03-03-25	TJH	A
projection	dwg no	111-25-02	